

Built Communities, Highways
2 Staffordshire Place
Tipping Street
Stafford
ST16 2DH

IMPORTANT

THIS IS NOT A CIRCULAR

Telephone: 01785 854713
Email: sandeep.aheer@staffordshire.gov.uk

Our Ref: SA/CONS/CDT6647

Your Ref: CDT6647

Date: 15 December 2017

Dear Sir/Madam,

Eastern Avenue and Stafford Road, Lichfield
No Waiting At Any Time and No Waiting Mon-Fri 7am to 7pm restrictions

I write to you in connection with a proposed Traffic Regulation Order (TRO) required as part of the new Lichfield Operational Police building development.

For reference, the scheme proposals is shown on the attached drawing. To summarise, the proposed scheme shows a No Waiting At Any Time restriction in Eastern Avenue and part of Stafford Road, and a new No Waiting Monday to Friday from 7 a.m to 7 p.m restriction in part of Stafford Road. This scheme will ensure that traffic flow along Eastern Avenue is not obstructed by parked vehicles and will help to maintain a safe access and egress from the new Police building development.

As part of Staffordshire County Council's consultation process and in order to get your view on the proposed measures, I would appreciate it if you could complete the enclosed response slip and return it to the address provided on the slip. Alternatively, you can email a scanned copy of the completed slip to the address provided above. The closing date for responses is **Monday 15th January 2018**.

If you have any questions or would like any further information, please do not hesitate to contact me using the details provided at the top of this letter.

Yours faithfully,

Sandeep Aheer
Senior Transport Planner
Staffordshire Design Hub



© Crown copyright and database rights 2017 Ordnance Survey 100019422
 You are not permitted to copy, sub-license, distribute or sell any of this data to third parties in any form.
 Produced by Staffordshire County Council, 2017.

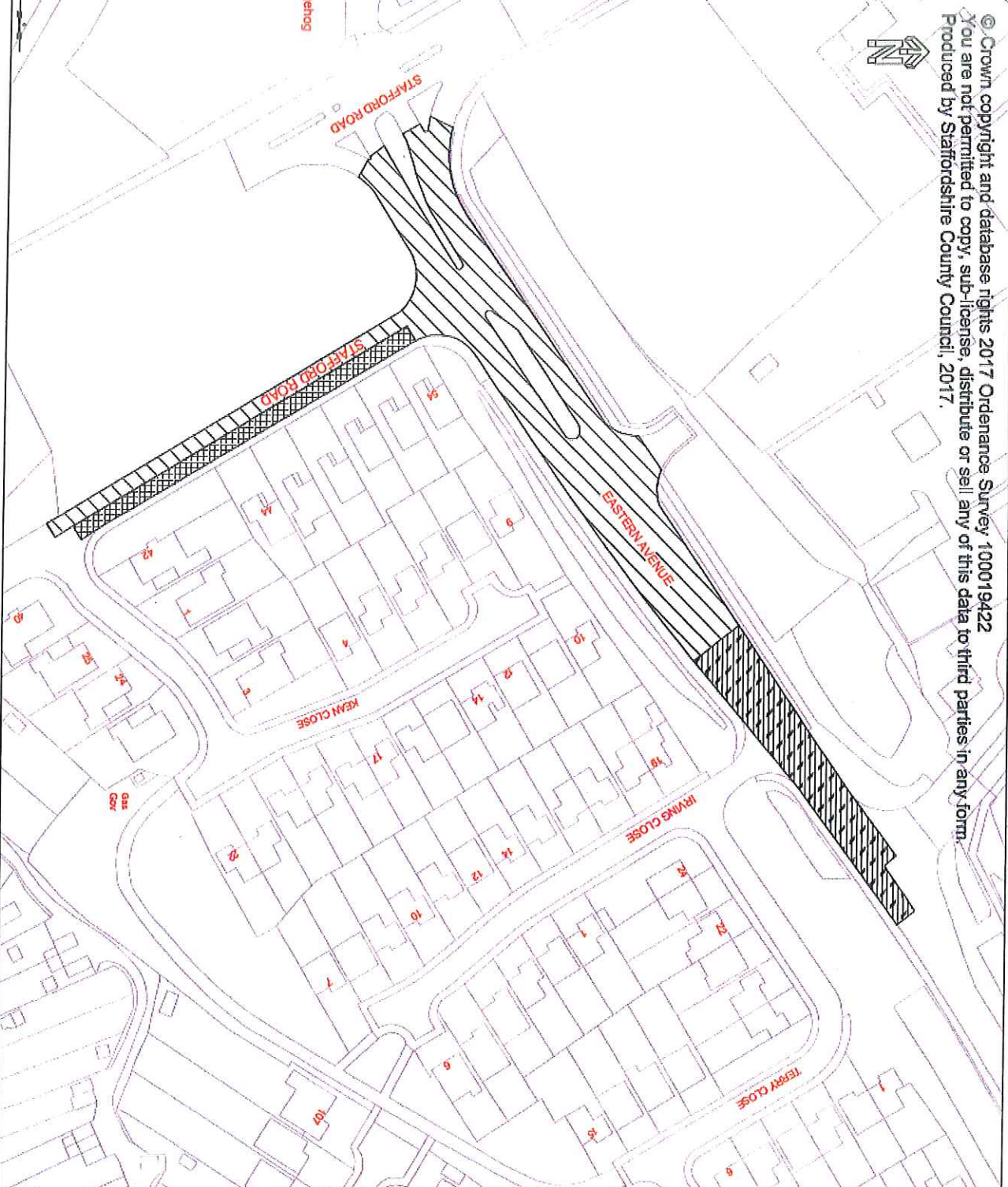

- Key**
- Proposed No waiting at any time restriction
 - Proposed No waiting Mon-Sat 7 am-7pm restriction
 - Extents of existing zig-zags for pedestrian crossing

Rev	Detail	By	Date

Revisions

Original Version	Preliminary
Design: IG	For comment
Design: SA	For tender
Date: OCTOBER 2017	For construction
	As constructed
	STATUS

Checked by: **Richard Smith**
 Design Engineer
 Date: 2017/10/17 14:28:42

Approved by: Drawing NOT approved (this box is empty)
 Richard Smith
 Design Engineer
 Date: 2017/10/17 14:28:42

Staffordshire County Council
 Working with
amey
 www.amey.com

Project Name:
**A5192-EASTERN AVENUE
 LICFIELD**

Drawing Title:
**LICFIELD OPERATIONAL POLICE
 BUILDING-WAITING RESTRICTIONS**

Drawing No:
CDT16648/R01/001

Grid reference: 410553,370543
 Original Drawing Size: A4 Dimensions: M
 Scale: 1:1250 Copyright © Amey

RESPONSE SLIP

Proposed No Waiting At Any time restriction in Eastern Avenue and No Waiting Mon-Fri 7.a.m. 7 p.m. restriction in part of Stafford Road

**Please indicate your support or objection to the above proposals by
Monday 15th January 2018:**

I support the proposal to restrict waiting in Eastern Avenue and Stafford Road as described above

I do not support the proposal to restrict waiting in Eastern Avenue and Stafford Road as described above

Comments

.....
.....
.....

Name

Address

.....

.....

Signed Date

Please return this form to:

Community Projects, Highways, Staffordshire County Council, 2 Staffordshire Place,
Tipping Street, Stafford, ST16 2DH.

FAO Sandeep Aheer, Senior Transport Planner (Design Hub)

